

# TYPE H

## Female connector – straight and angled – 15 positions

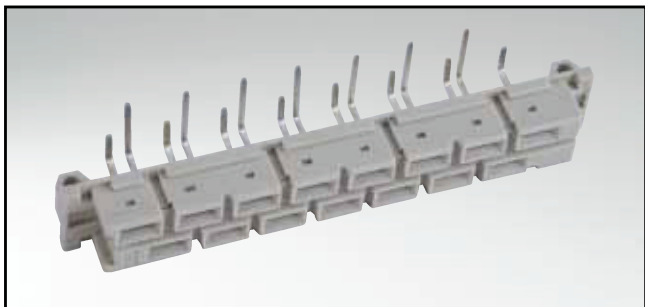

RoHS compliant

### DESCRIPTION

- Solder pin, solder lug, Faston- and screw termination
- With breakout area for coding
- Contact plating: silver

### PRODUCT DRAWING

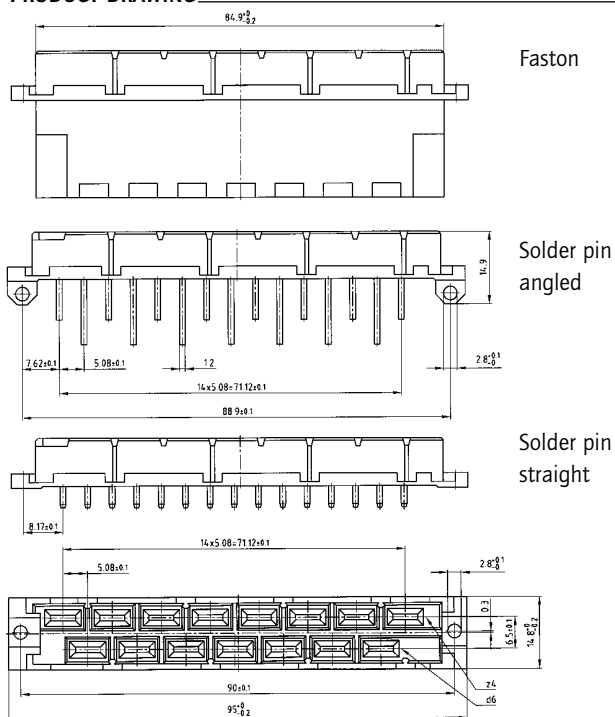

### PCB-hole pattern

#### Solder pin angled 5.08 mm

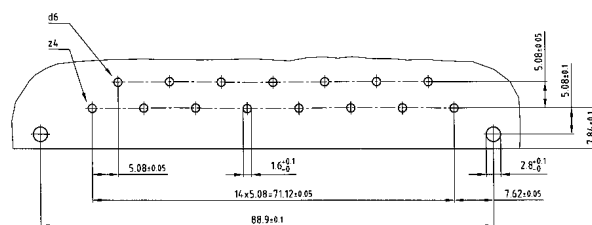

#### Solder pin straight 10.16 mm

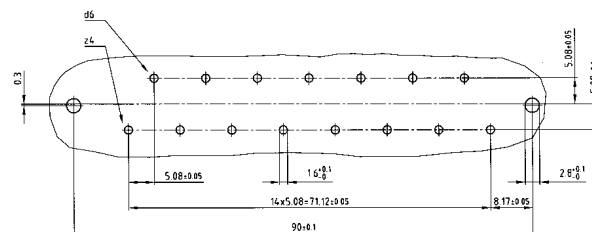

#### Faston

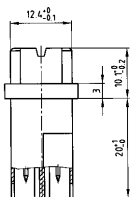

#### Screwed connection

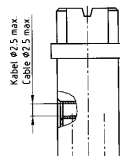

#### Solder pin straight 4.5 mm

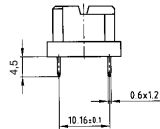

#### Solder pin straight 13 mm

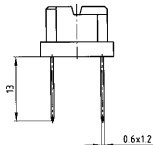

#### Solder lug

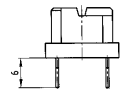

#### Solder pin angled

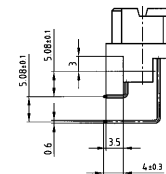

#### Coding piece



(Dim. = mm)

### ORDER DATA

No. of Pos.	Faston	Screwed connection	Solder pin straight 4.5 mm	Solder pin straight 13 mm	Solder lug	Solder pin angled	Coding piece
15	122 E 11609 X	122 E 11619 X	122 E 11629 X	122 E 11639 X	122 E 11649 X	122 E 11659 X	120 X 10019 X