

Product- information Type: PR290/1000/SE

Group: Extruded heatsinks (Standard)

Extruded heatsinks (Meter length)

Width:	23 mm
Height:	30 mm
Length:	1000 mm
Weight:	705 g
Surface area:	2355 cm ²
Finish:	black anodized
Material:	Aluminium
Alloy:	AlMgSi 0,5 F22
Tolerance:	DIN 1748 Bl.4

Extruded heatsink especially for semiconductor in case TO220; TO218(TOP3).

Standard type, ready to be fitted:
PR 290/94/M3 = with notch for clip mounting

Suitable mounting clip: MC 725, MC 726, MC 773 and MC 797.
Space saving mounting e.g. on Eurocard-PCB's.
Mounting of heatsinks with M3 screws (screw-groove)

Other standard lengths for PR 290 = 37,5, 50, 75 and 100 mm.

Also available in meter lengths.
Other lengths and machining on request.

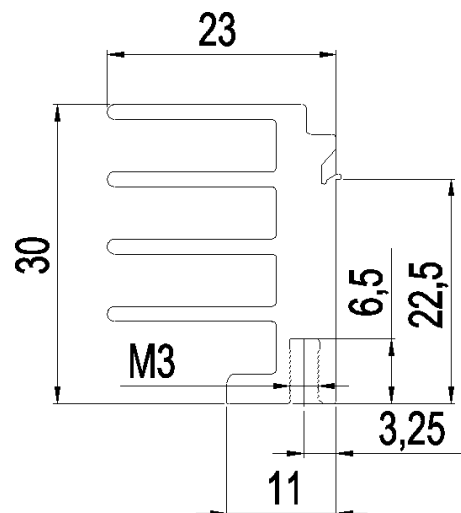
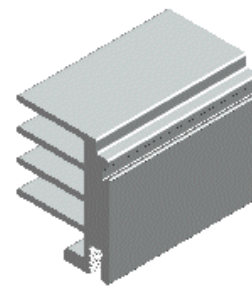

Pv (w)	R thk (K/W)			
2,5	14,5	12,6	10,5	9,1
5	12,7	10,9	8,8	7,5
7,5	11,7	9,9	8,0	6,7
10		9,3	7,7	6,4
12,5			7,2	6,2
l (mm)	37,5	50	75	100
A (cm ²)	93	107	181	410
V (cm ³)	10	13	20	26
m (g)	26	35	53	70

All the measurements were obtained under the following conditions:

- + Heatsink anodised matt black
- + Fins arranged vertically
- + One heat source in centre of heatsinks (unless otherwise stated)
- + Temperature measured between the adjacent surface of semiconductor and heatsink
- + Heatsink compound used
- + Surround temperature measured at 1 metre distance from object

More details see 'technical information'.

