

REV.	DESCRIPTION	DATE	APRVD
A	INITIAL RELEASE	05/03/08	---

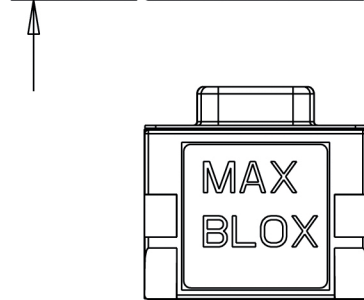

SUGGESTED CUTOUT

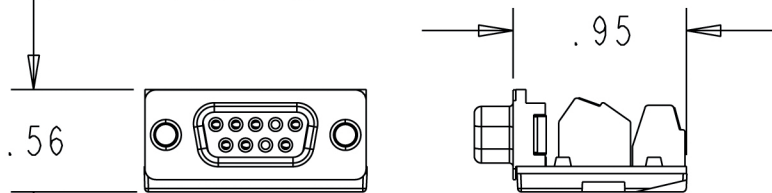
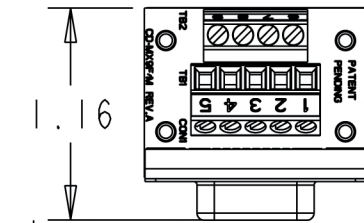
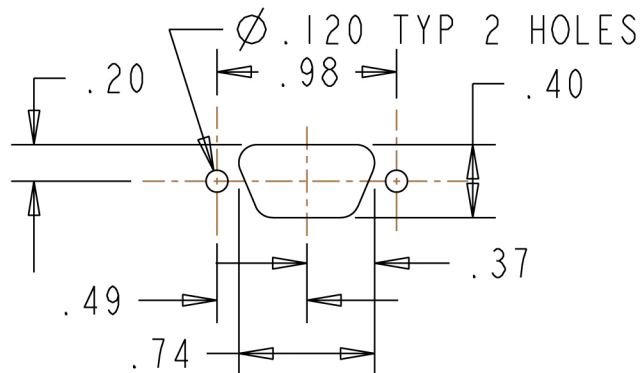

NOTE

- 1) MAXBLOX SERIES CONNECTOR WILL MATE WITH HOOD AND HALF HOOD
- 2) TERMINAL BLOCKS WILL ACCOMODATE WIRE GA 30AWG-16AWG
- 3) WIRING IS PIN FOR PIN
(IE.. PIN#1 DB9 GOES TO PIN#1 MARKED ON TERM BLOCK)
- 4) #4-40 JACKSCREWS AND SHOULDER SCREWS SUPPLIED IN BAG

PART DIMENSIONAL TOLERANCES

ALL DIMENSIONS ARE INCHES [mm]
 .XX = $\pm .015$ [0.4mm]
 .XXX = $\pm .005$ [0.1mm]
 ANGULAR = $\pm 1/2^\circ$

DO NOT SCALE FROM DRAWING

DRAWN:	CWD	DATE:	05/03/08
APRVD:	---	DATE:	MM/DD/YYYY
FIRST PRODUCT:	-----		
DRAWING SCALE	1 = 1		

CUSTOMER DRAWING, 9 PIN FEMALE

RoHS COMPLIANT?	SIZE	DOC#	AB4000	REVISION
YES	A			A
FILENAME:	CD-MX9F	SHEET	#1 OF 1	DATE 05/03/08