



USB 3.2 Gen2x1 Type C Active Optical Cable



User Manual
USC-CC32

Manual Contents

Manual Contents	1-0
USC-CC32, Product Description	1-1
System Requirements for Setup	1-2
Installation	1-3
Troubleshooting, Maintenance, Technical Support	1-4
Product Specifications	1-5
Warranty Information	1-6

Welcome!

Congratulations on your purchase of the USB 3.2 Gen2x1 Type C Active Optical Cable, USC-CC32! This manual contains information that will assist you in installing and operating the product.

Product Description

Shipping Group

- ☐ **USC-CC32, USB 3.2 Gen 2x1 Type C Active Optical Cable**
- ☐ **(Optional) Locking accessory**

* Contact the regional sales representative or tosales@opticis.com for more information.

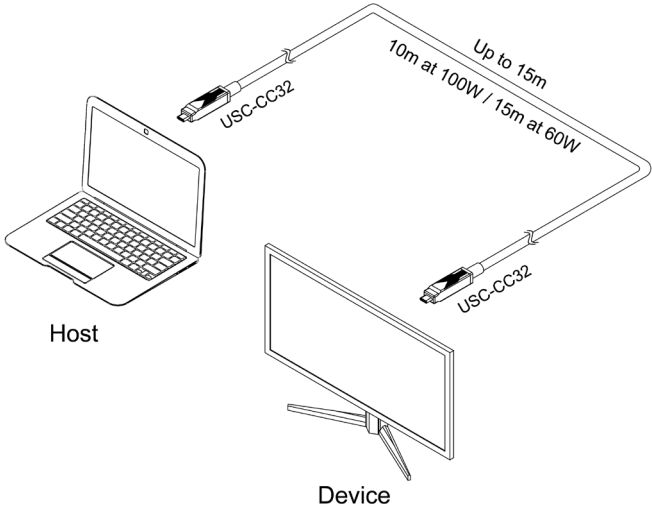

Figure 1 – General connection diagram of USC-CC32

System Requirements for Setup

□ Hardware requirements

- You may have a USB Type C receptacle in Host (PC or laptop) or Device (hub, webcam, display, flash drive or HID devices) to be connected.
- No special requirements for memory size, CPU speed and chipsets, if you've already properly installed your USB controllers or cards.

□ Software requirements

- No special restrictions, if you've already properly installed your USB controller in your Windows or Mac systems.

Note 1: USC-CC32 was tested for compatibility with Apple's MacBook. Contact the regional sales representative or tosales@opticis.com for more test results with other hosts and devices.

Note 2: USC-CC32 can be provided in various jacket type as UL or non-UL.

1-2 System Requirements for Setup

Installation

Important: Please use the installation procedure below. Improper or no operation may result if the start-up sequence is not correctly followed.

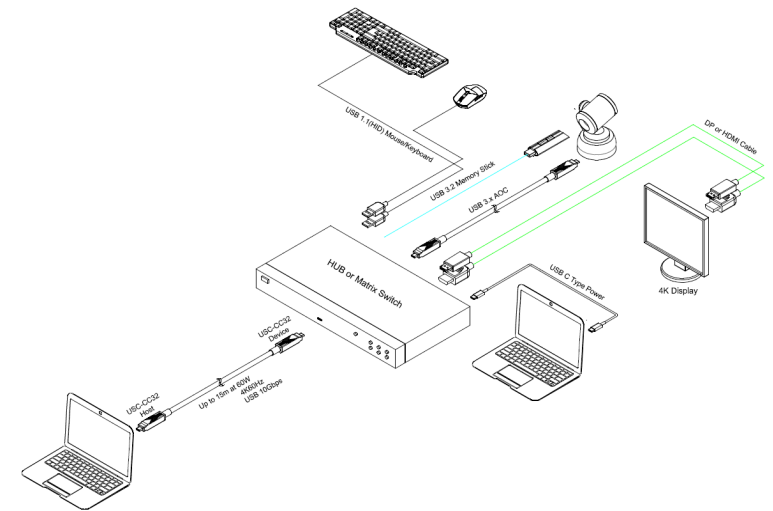

Step 1

Carefully unpack the contents of the shipping group. One USC-CC32 Type C connector is marked "host" and the other USC-CC32 Type C connector is marked "device" to ensure that the source and device are properly connected.

Step 2

Connect the USC-CC32 Type C host connector to host computer's USB 3.0 port.

Step 3

Connect the USC-CC32 Type C device connector to the USB Hub. Then, proceed to connect the display or the desired device after attaching the power adapter to the hub.

Step 4

Once connected, check the Windows Device Manager to verify the devices that have been successfully connected through the device driver controller.

Note 1: Locking accessory consist of a screw and a holder to tighten the USC-CC32 cable from accidental disconnection. Contact the regional sales representative or tosales@opticis.com for more information.

1-3 Installation

Troubleshooting

Your USB device connected to USC-CC32 does not work properly.

First, ensure the USB connector is properly connected to the appropriate ports on both the host and device. If the connections are correct, check the Window Device Manager to see if the device driver is installed. If not, visit the manufacturer's website of your USB device to download the appropriate device driver and reinstall it. Alternatively, contact Opticis or manufacturer of device for the future assistance.

Want to use multiple connections with USB hub.

For details on compatible hub type, please reach out to your regional sales representative or email us at tosales@opticis.com.

The generic USB hub under USB controller cannot be seen in Windows System Manager.

If it is not visible in the Windows System Manager after following the installation steps outlined in 1-3, attempt to disconnect and reconnect the product. If the issue persists, reboot your PC and reinstall the product as instructed in 1-3.

Maintenance

No special maintenance is required for the hybrid USB extension cables. Ensure that the cables are stored or used in a benign environment free from liquid or dirt contamination.

There are no user serviceable parts. Refer all service and repair issues to Opticis.

Technical Support and Service

For commercial or general product support, contact your reseller. For technical service, contact Opticis by email techsupp@opticis.com or visit our website at www.opticis.com

Product Specifications

USC-CC32, USB 3.2 Gen2x1 Type C Active Optical Cable

- ❑ **USB Type C Male to Male Connector**
- ❑ **SuperSpeed** USB 3.2 Gen 2x1(10Gbps) data up to 15m (50ft)
- ❑ **Backward compatibility** with USB 2.0 and 1.1.
- ❑ **Power delivery** 100W at 10m (33ft) or 60W at 15m (50ft)
- ❑ **DisplayPort Alt mode** supports up to 4K@60Hz (2 DisplayPort lanes, 8.1Gbps/lane)
- ❑ **Plug and Play**
- ❑ **Designed** to prevent ESD, EMI, and RFI
- ❑ **No** external power is required

- ❑ Cable pulling strength: 20Kgf
 - Minimum bending radius:
PVC: 112.5mm
 - Outer diameter of cable
PVC: 7.3Φ ±0.3

- ❑ Physical Characteristic
 - Dimensions: 13 x 47 x 11mm (WxLxH)

- ❑ Operating Condition
 - Operating temperature: - 10°C to 60°C
 - Storage temperature: - 10°C to 70°C
 - Humidity: 10% to 90%

Warranty Information

1 (One) Year Warranty

Opticis warrants this optical DisplayPort extender to be free from defects in workmanship and materials, under normal use and service, for a period of one (1) year from the date of purchase from Opticis or its authorized resellers.

If a product does not work as warranted during the applicable warranty period, Opticis shall, at its option and expense, repair the defective product or part, deliver to customer an equivalent product or part to replace the defective item, or refund to customer the purchase price paid for the defective product.

All products that are replaced will become the property of Opticis. Replacement products may be new or reconditioned. Any replaced or repaired product or part has a ninety (90) days warranty or the remainder of the initial warranty period, whichever is longer.

Opticis shall not be responsible for any software, firmware, information, or memory data of customer contained in, stored on, or integrated with any products returned to Opticis for repair under warranty or not.

Warranty Limitation and Exclusion

Opticis shall have no further obligation under the foregoing limited warranty if the product has been damaged due to abuse, misuse, neglect, accident, unusual physical or electrical stress, unauthorized modifications, tampering, alterations, or service other than by Opticis or its authorized agents, causes other than from ordinary use or failure to properly use the Product in the application for which said Product is intended.

Dispose of Old Electrical & Electronic Equipment

(Applicable in the European Union and other European countries with separate systems)



This symbol on the product or on its packaging indicates that this product shall not be treated as household waste. Instead, it shall be handed over to the applicable collection point for the recycling of electrical and electronic equipment. By ensuring this product is disposed of correctly, you will help prevent potential negative consequences for the environment and human health, which could otherwise be caused by inappropriate waste handling of this product.

The recycling of materials will help to conserve natural resources. For more detailed information about recycling of this product, please contact your local city office, your household waste disposal service or the shop where you purchased the product.

1-6 Warranty Information

© 2024 Opticis Co., Ltd. All Rights Reserved
Version 1.0_June 2024

Opticis Locations

Headquarters

Opticis Co., Ltd.
3F, 305, Sanseong-daero
Sujeong-gu, Seongnam-si
Gyeonggi-do, 13354
South Korea
Tel: +82 (31) 719-8033
Fax: +82 (31) 719-8032
www.opticis.com

For order support, please contact your Distributor or Reseller.

For technical support, check with the Opticis web site www.opticis.com or contact techsupp@opticis.com